

## How to link the Robust Health app to a treatment center after your account or a profile has been created.

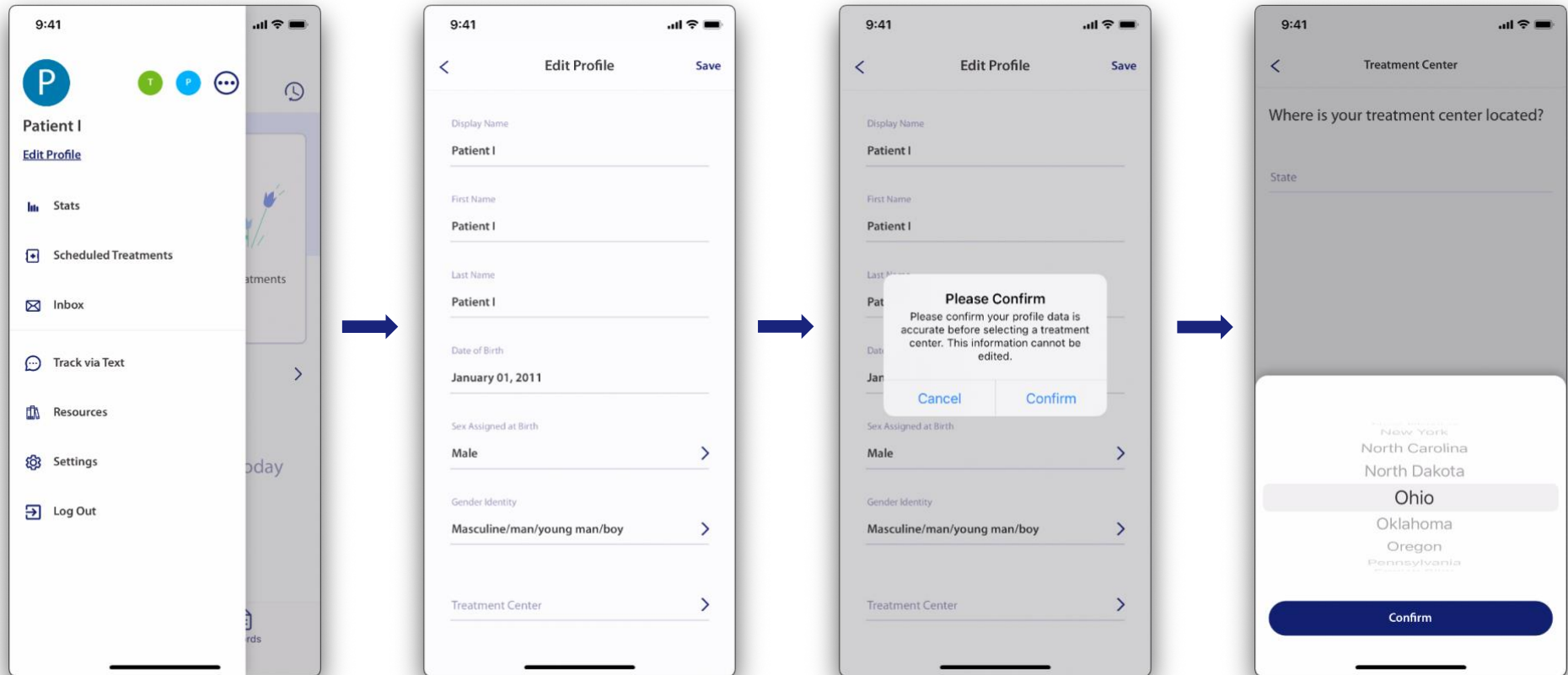

1. Open the **Menu**, then tap **Edit Profile**.
2. Scroll down to the bottom of the page and tap **Treatment Center**.
3. You will be asked to confirm your profile data is accurate. Tap **Confirm**.
4. Tap **State**. Next, select the state your treatment is located in using the scroll wheel, then tap **Confirm**.

*Note: The Menu icon is the three horizontal lines you see on your home page in the top left corner of your screen.*

Tap **Cancel** to return to the **Edit Profile** screen.

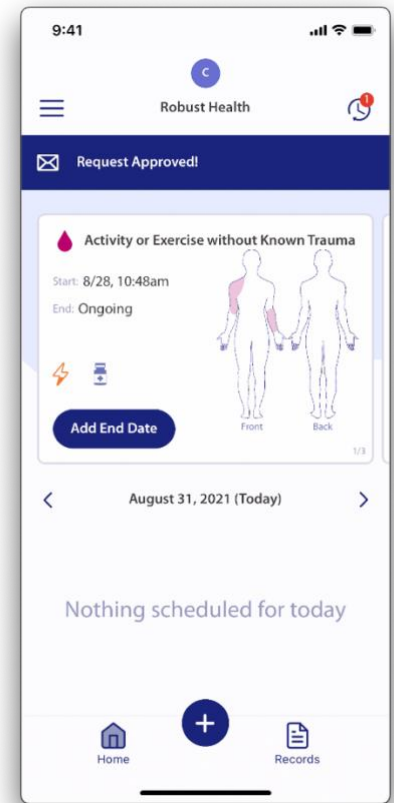
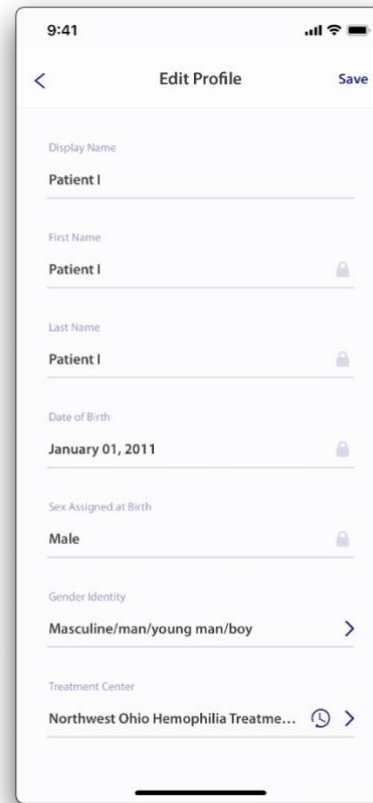

5. Tap the name of your treatment center, then tap **Link Treatment Center**.

6. Tap **Done**.

7. The **Treatment Center** value becomes non-editable, and a pending symbol will be displayed next to the name of the treatment center until the request is approved. Tap **Save**.

8. Once the treatment center approves your request, you will receive a notification on your **Home** page. Tapping the notification will open it and you will be taken to your **Inbox**.

Congrats your data is now being shared with your treatment center!